



STREAM XD / XD2



OWNER'S MANUAL

Introduction

OSD – The Best Value in Sound

Thanks for joining the OSD owners club.

Thank you for purchasing the NERO Stream XD/XD2 Integrated AMP/Preamp Wi-Fi Streamers. This single-zone amp/preamp is ideal for commercial and residential applications. The XD and XD2 are compatible with the OSD Player app for selecting and controlling multiple Sources/Music services. They can be grouped with other OSD streaming and integrated amp/preamps.

Remove the XD or XD2 from the box and look over the device to ensure it is free of damage and that all the packaging contents are accounted for before proceeding.

Connect the Wireless BT and Wi-Fi antennas to the back panel connectors. Find the AC Power Cord and connect it to the XD or XD2 before plugging it into an AC outlet.

This manual provides additional connection options. When connecting or disconnecting other devices, ensure the XD or XD2 is not powered on.

If you have any questions about your XD or XD2, please get in touch with us

www.osdaudio.com

email: support@osdaudio.com



Phone: 888-779-4968

In The Box

QR Manual Card	Qty: 1
12Volt 1A US Power Adapter	Qty: 1
Antennas	Qty: 2
IR Remote Control	Qty: 1
Wall Mount Brackets	Qty: 2
Wall Mount Bracket Hardware	Qty: 4

WARNING

- TO PREVENT FIRE OR SHOCK HAZARD, DO NOT USE THIS PLUG WITH AN EXTENSION CORD, RECEPTACLE OR OTHER OUTLET UNLESS THE BLADES CAN BE FULLY INSERTED TO PREVENT BLADE EXPOSURE.
- TO PREVENT FIRE OR SHOCK HAZARD, DO NOT EXPOSE THIS APPLIANCE TO RAIN OR MOISTURE.
- TO PREVENT ELECTRICAL SHOCK, MATCH WIDE BLADE PLUG TO WIDE SLOT, FULLY INSERT.

 <p>This lightning flash with arrowhead symbol, within an equilateral triangle, is intended to alert the user to the presence of un-insulated dangerous voltage within the products enclosure that may be of sufficient magnitude to constitute a risk of electric shock to persons.</p>	<p>CAUTION</p> <p>RISK OF ELECTRIC SHOCK DO NOT OPEN</p> <p>This lightning flash with arrowhead symbol, within an equilateral triangle, is intended to alert the user to the presence of un-insulated dangerous voltage within the products enclosure that may be of sufficient magnitude to constitute a risk of electric shock to persons.</p>	 <p>The exclamation point within the equilateral triangle is intended to alert the user to the presence of important operating and maintenance (servicing) instructions in the literature accompanying appliance.</p>
---	---	--

IMPORTANT SAFETY INSTRUCTIONS

1. Read these instructions.
2. Keep these instructions.
- 3 Read all warnings.
- 4 Follow all Instruction.
5. Do not use this apparatus near water.
6. Clean only with dry cloth.
7. Do not block any ventilation openings. Install in accordance with the manufacturers instructions.
8. Do not install near heat sources such as radiators, heat registers, stoves, or other apparatus (including amplifiers) that produce heat.
9. Do not defeat the safety purpose of the polarized or grounding type plug. A polarized plug has two blades with one wider than the other. A grounding type plug has two blades and a third grounding prong. If the provided plugs does not fit into your outlet, consult an electrician for replacement of the obsolete outlet.
10. Protect the power cord from being walked on or pinched particularly at the plugs, convenience receptacles, and at the point where they exit form the appliance.
11. Only use attachments or accessories specified by the manufacturer.
12. Unplug the apparatus during lightning storms or when unused for long periods of time.
13. Refer all servicing to qualified personnel. Servicing is required when the apparatus has been damaged in anyway, such as power supply cord or plug is damaged, liquid has been spilled or objects have fallen into the apparatus, the apparatus has been exposed to rain or moisture, does not operate normally, or has been dropped.

Front/Rear Panel STREAM XD



- 1. POWER SWITCH:** Used to turn on or off power of the Integrated Amplifier, POWER/STATUS INDICATING LED: The green light indicates normal operation, the red light indicates standby mode.
- 2. SOURCE SELECTED STATUS INDICATING LED:** LEDs 1-3; BT, OPTIC, and DAC, LEDs 4-7: ARC, COAX, LINE, WIFI. BT LED is Blue, all other Source LEDs are White Mist
- 3. VOLUME/SOURCE SELECT ENCODER:** Multi- function knob, the encoder is rotated to the left for volume – and to the right for volume +. Press the encoder's touch switch to switch the sound source, switching one sound source with each press. Press and hold the encoder's touch switch to restore the power amplifier's factory settings. Press the encoder to tap the switch in the standby state to wake up the power amplifier.
- 4. IR REMOTE SENSOR:** The IR window is used to receive the infrared signal of the remote control.

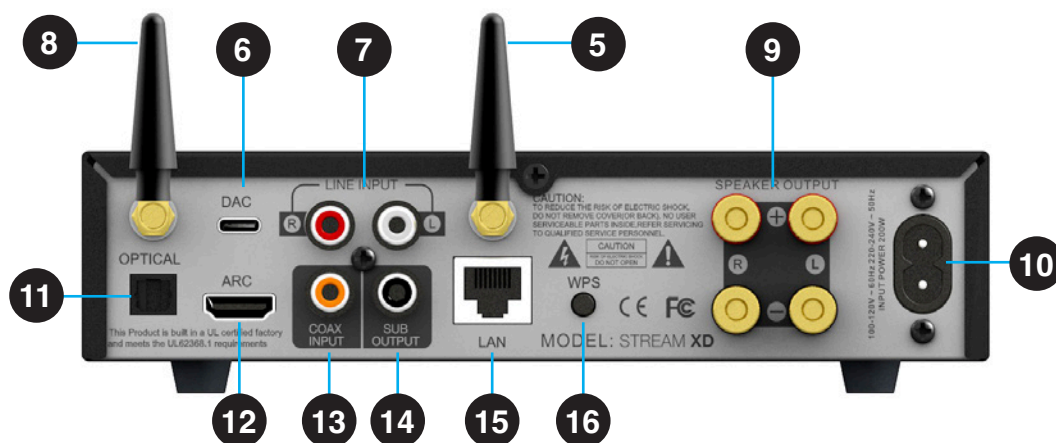

- 5. WIRELESS BT ANTENNA:** To maintain the stability of Wireless BT communication, it is necessary to rely on the assistance of external antennas, which will significantly improve the distance and stability.
- 6. DAC INPUT** is used to play UD-disk music and connect native digital computer playback.
- 7. AUX LINE IN ANALOG INPUT:** Can be connected to a CD, DVD, set-top box, and other audio sources with analog audio output devices.
- 8. WIRELESS WIFI ANTENNA:** Option #2 supports Wi-Fi wireless connection.
- 9. SPEAKER WIRE OUTPUT TERMINALS:** Can connect 4 - 16 ohms of the passive speaker. Connect single pair of 4 or 8-ohm speakers. Two pair of 8-ohm speakers can be connected in Parallel to drive a 4-ohm load.
- 10. AC OUTLET:** Connects AC Power Cord. It supports AC 100 - 120V/220 - 240V voltage input and can adapt to the power supply voltage of different countries worldwide.
- 11. OPTIC DIGITAL INPUT:** Connect some devices with OPITC output to achieve sound source playback, such as TVs, AVRs, and Karaoke machines.
- 12. HDMI ARC INPUT:** Some devices with ARC, such as TVs and karaoke machines, can be connected to achieve music playback.
- 13. COAX INPUT:** Some devices with COAX output, such as TVs and karaoke machines, can be connected to achieve music playback.
- 14. SUB OUTPUT:** It connects to an active subwoofer or independent Subwoofer with Passive Subwoofer for a stronger bass effect.
- 15. LAN CONNECTION:** Option#1 is a direct connection to your network for Wi-Fi.
- 16. WPS BUTTON:** Use when needing to connect Wirelessly in case a LAN connection is not an option

Front/Rear Panel STREAM XD2



- 1. POWER SWITCH:** Used to turn on or off power of the Integrated Amplifier, POWER/STATUS INDICATING LED: The green light indicates normal operation, the red light indicates standby mode.
- 2. SOURCE SELECTED STATUS INDICATING LED:** LEDs 1-3; BT, OPTIC, and DAC, LEDs 4-7: ARC, COAX, LINE, WIFI. BT LED is Blue, all other Source LEDs are White Mist
- 3. VOLUME/SOURCE SELECT ENCODER:** Multi- function knob, the encoder is rotated to the left for volume – and to the right for volume +. Press the encoder's touch switch to switch the sound source, switching one sound source with each press. Press and hold the encoder's touch switch to restore the power amplifier's factory settings. Press the encoder to tap the switch in the standby state to wake up the power amplifier.
- 4. A&B SPEAKER SELECTOR BUTTONS:** Choose Speaker A or B, and A & B at the same time.
- 5. IR REMOTE SENSOR:** The IR window is used to receive the infrared signal of the remote control.

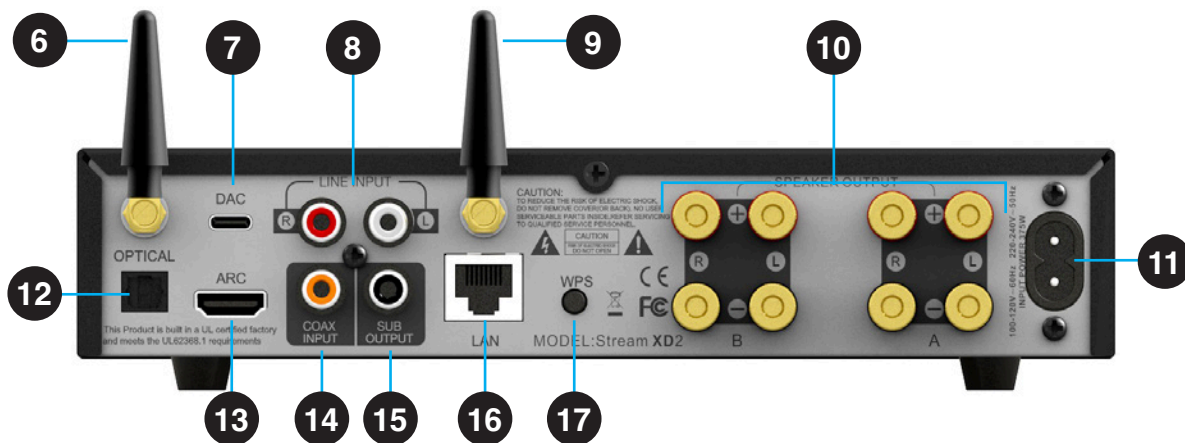

- 6. WIRELESS BT ANTENNA:** To maintain the stability of Wireless BT communication, it is necessary to rely on the assistance of external antennas, which will significantly improve the distance and stability.
- 7. DAC INPUT** is used to play UD-disk music and connect native digital computer playback.
- 8. AUX LINE IN ANALOG INPUT:** Can be connected to a CD, DVD, set-top box, and other audio sources with analog audio output devices.
- 9. WIRELESS WIFI ANTENNA:** Option #2 supports Wi-Fi wireless connection.
- 10. SPEAKER WIRE OUTPUT TERMINALS A & B:** Can connect 4 -16 ohms of the passive speaker. Connect single pair of 4 or 8-ohm speakers to A or B only. Two pair of 8-ohm speakers can be connected to either A or B in Parallel to drive a 4-ohm load. Or you can connect a pair of 8-ohm speakers to A and B.
- 11. AC OUTLET:** Connects AC Power Cord. It supports AC 100 - 120V/220 - 240V voltage input and can adapt to the power supply voltage of different countries worldwide.
- 12. OPTIC DIGITAL INPUT:** Connect some devices with OPITC output to achieve sound source playback, such as TVs, AVRs, and Karaoke machines.
- 13. HDMI ARC INPUT:** Some devices with ARC, such as TVs and karaoke machines, can be connected to achieve music playback.
- 14. COAX INPUT:** Some devices with COAX output, such as TVs and karaoke machines, can be connected to achieve music playback.
- 15. SUB OUTPUT:** It connects to an active subwoofer or independent Subwoofer with Passive Subwoofer for a stronger bass effect.
- 16. LAN CONNECTION:** Option#1 is a direct connection to your network for Wi-Fi.
- 17. WPS BUTTON:** Use when needing to connect Wirelessly in case a LAN connection is not an option

Remote Control

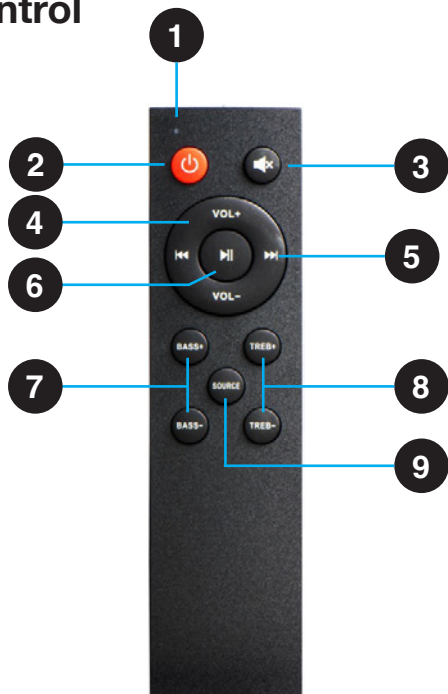

1. Power LED Flashing Indicator
2. Power Button
3. Volume Mute Button
4. Volume +/-
5. Forward/Rewind
6. Pause/Play Button
7. Bass +/-
8. Treble +/-
9. Source Select Button (Left to Right)
Wireless BT, Digital Optic, and DAC/USB-C
ARC, Digital COAX, Analog Line In, and Wi-Fi

NOTE: For IR Codes See Page 11.

Connection Options Diagram

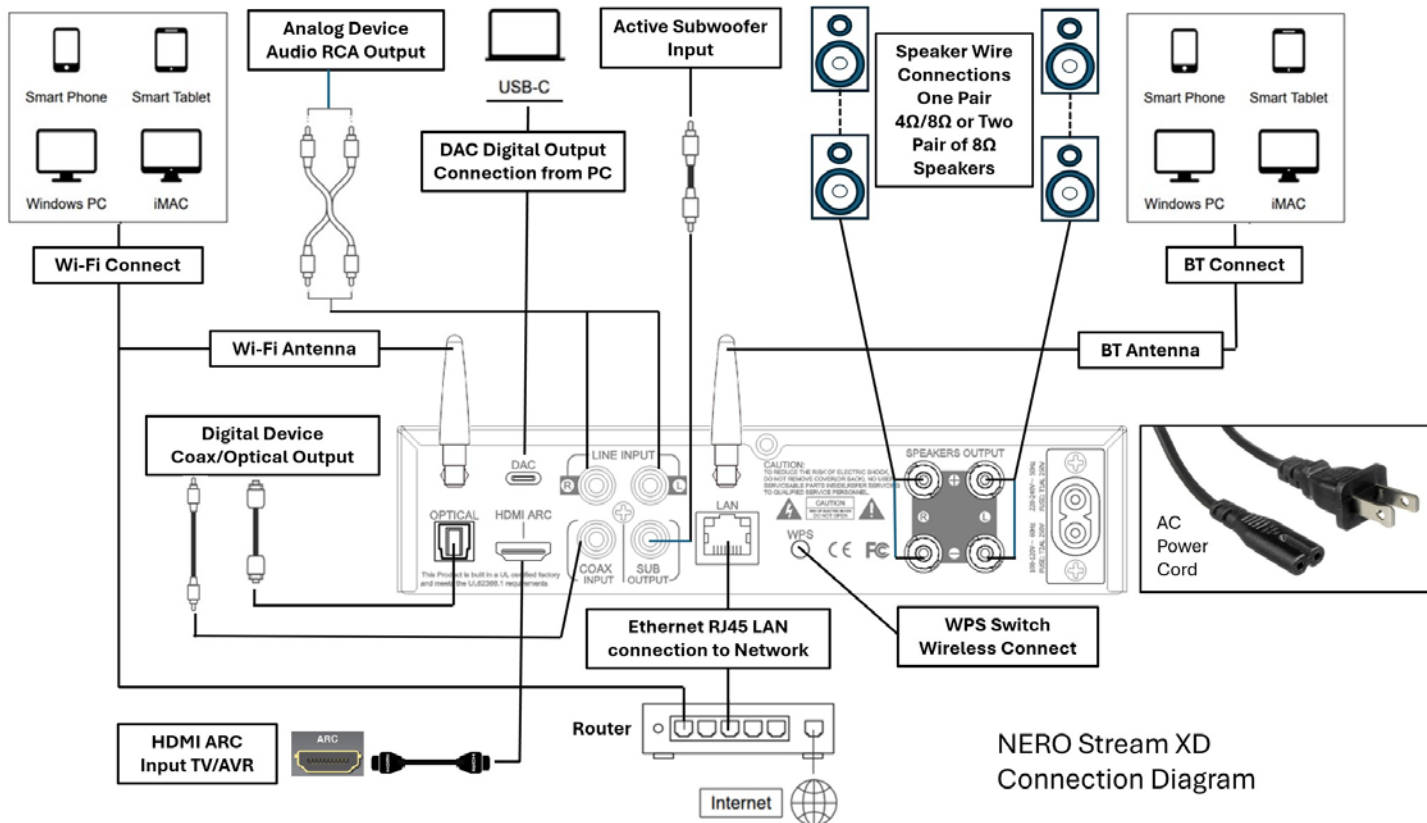

Setup & Operation

Once the NERO Stream XD or XD2 are connected and in the desired location, plug the AC Power Cord into the XD or XD2 to an available AC outlet.

Note that the XD or XD2 can connect directly to the network by connecting a network cable to the LAN connection on the back panel. It can also connect wirelessly, especially if no LAN connection is near the NERO Stream XD or XD2 install location.

The next step is to connect the NERO Stream XD or XD2 to your network and control the sources using the OSD Audio Player App.

LAN Direct Wire/Cable connectivity for STREAM XD/XD2

1. Download and install the OSD app by scanning the QR code or search “OSD Player” in the App store/ Google Play store.



Direct LAN
Connect Option

2. Connect the XD/XD2 to your network router using the RJ45 Ethernet LAN port on the rear panel.
3. LAN connection will automatically setup a zone for the XD/XD2. Ensure your mobile device is connected to the same network and open the OSD Audio Player App

Connection Via Wireless BT Receiver Mode

The XD and XD2 features Wireless BT Connect as an option. You can access the Wireless BT 5.0 using the OSD Audio Player App, manually using the front panel Volume/Source Select Knob, or by using the IR Remote that is included with the NERO Stream XD and XD2.



When in receiver mode, the BT LED will be flashing which indicates it is waiting for connection in your BT Transmitter device (cell phone, pad, TV) you can search device name “OSD Player”.

Once connected, the BT LED will stay on which indicates the connection is successful and you can start playing music from the connected device and hear the sound coming out of the connected passive speakers.

XD/XD2 Streaming Services:

Listen to Online Music

The XD/XD2 can work with many popular streaming music services like Spotify, Tidal, Napster, and AMAZON MUSIC. Plus, Internet Radio Apps like TuneIn, iHeartradio, and VTuner. You can easily stream music or playlists from your account wirelessly and listen on your home audio system.

Spotify

To use Spotify, you will need to have Spotify premium account. You will find the OSD Audio Streaming device in the device list in Spotify Application and choose that device you want to stream.

AMAZON Music

To use AMAZON Music like Spotify, you will need to have an AMAZON Music premium account as well. You will find the OSD Audio Streaming device in the device list in AMAZON Music Application and choose that device you want to stream.

Airplay 1

The device supports Airplay1, you can choose Airplay1 in iOS device and play music.

Listen to local music

The XD/XD2 can stream local music stored in your Smartphone, USB storage device, NAS using DLNA protocol, PC software like iTunes, or UPnP/DLNA 3rd party software. Click on “My Music” to select the local device you want to play from.

Note: iOS-based devices have blocked the access to iTunes library. Our system only supports NAS using DLNA protocol.

Using the XD/XD2

Once you have connected your mobile to network and installed the OSD Audio Player App in your mobile device, you can start playing music to different rooms or the same music in all rooms in sync.

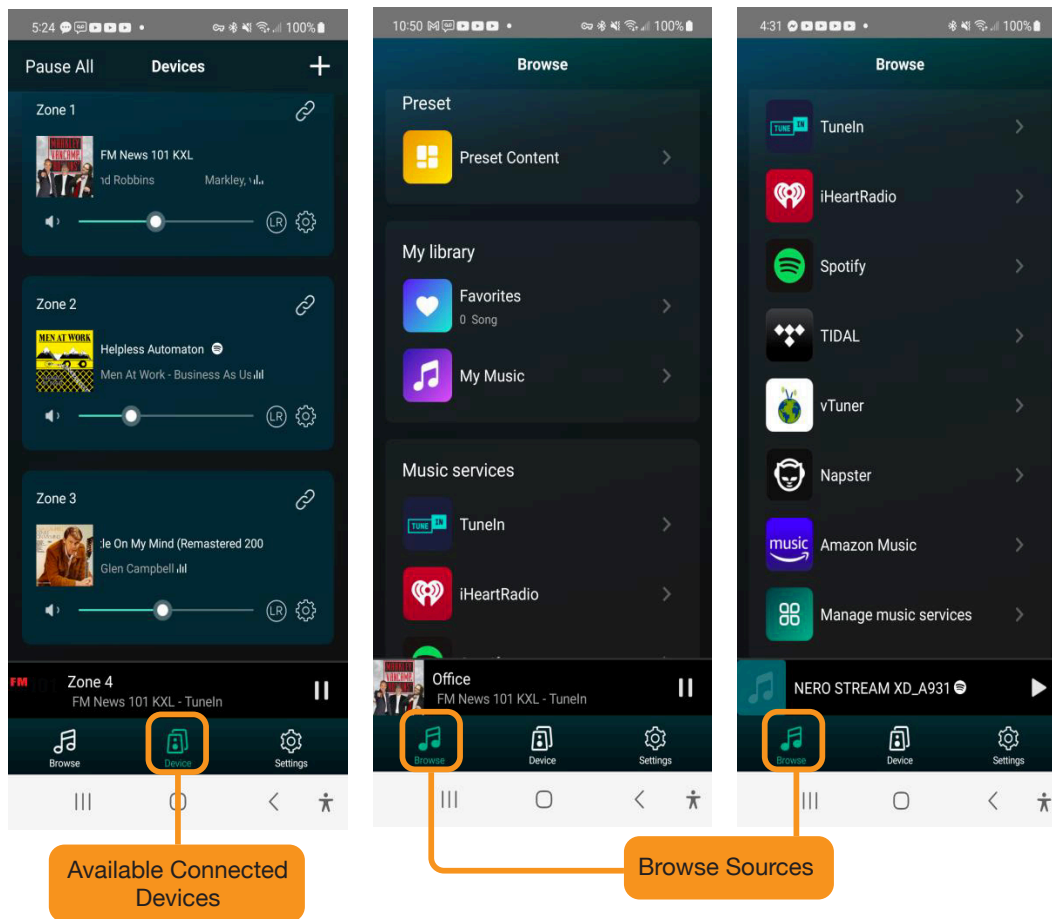

Selecting a Zone

In the OSD Audio Player APP you will see all the connected devices in the same network

1. Select the device you want to control; A green rectangle will highlight the selected Device
2. Select Browse on left side of the Bottom Tool Bar, note the highlighted selection turns dark green
3. From the Browse Screen, Select an online or local music source from the list to start streaming your music (Some sources will need a subscription)

Play the Same Music in Multiple Rooms

Using the OSD Audio Player App, you can play the same music in multiple rooms simultaneously by grouping two or more devices. First, in the Device screen, you select the primary Device (Highlighted by a green rectangle).

Select the Link in the upper right corner of the highlighted Device. A new screen will then appear featuring the selected Primary device and a blank circle for each additional device available to group with it. Just select the devices you want to add and Press the Done Button. Another Screen shows The Group Volume Master control, followed by the primary individual volume control and the independent volume for each grouped Zone.

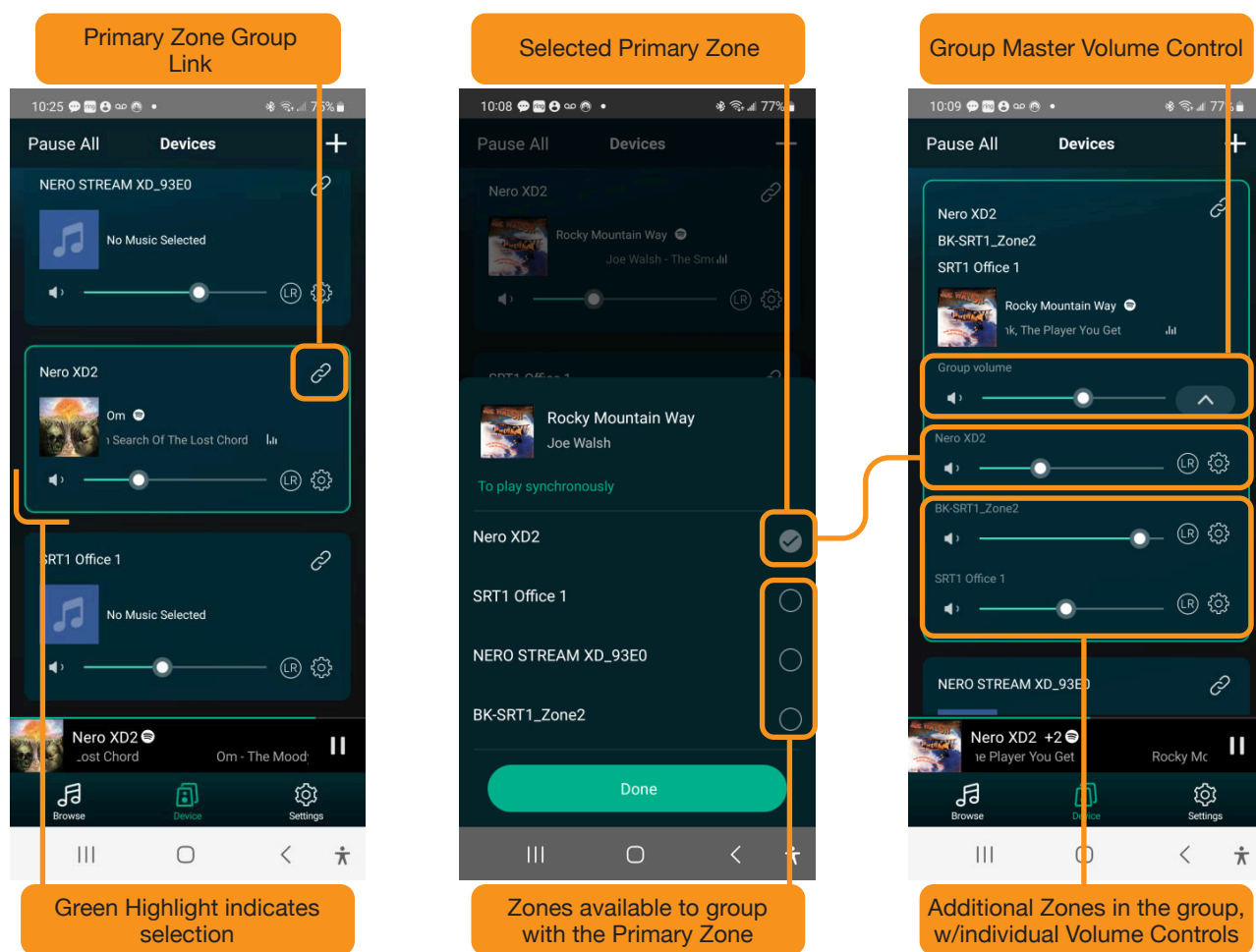

Universal IR Remote Codes



FUNCTION	CODE	
	HEX	HEX
POWER	45	BA
MUTE	47	B8
VOL +	15	EA
VOL -	18	E7
REWIND	07	F8
FORWARD	0C	F3
PLAY/ PAUSE	1A	E5
BASS +	09	F6
BASS -	42	BD
TREB +	5E	A1
TREB -	4A	B5
SOURCE	2A	D5

	STREAM XD2	STREAM XD
Amplifier Type	Hi-Res/Stereo	Hi-Res/Stereo
Design Type	Digital Class D	Digital Class D
Channels	4 W/Speaker A and B	2
Wifi Band	2.4G	2.4G
Peak Power Output	300W/Ch @ 4 Ohm	150W/Ch @ 4 Ohm
	75W x 2 RMS, 2 x 150W Peak Power Output @ 8 Ohm 24.5Vrms	37.5W x 2 RMS, 2 x 75W Peak Power Output @ 8 Ohm 17.3Vrms
	150W x 2 RMS, 2 x 300W Peak Power Output @ 4 Ohm 24.5Vrms	75W x 2 RMS, 2 x 150W Peak Power Output @ 4 Ohm 17.3Vrms
Frequency Response	20Hz-20kHz	20Hz-20kHz
Impedance	8 Ohm to 4 Ohm Stable	8 Ohm to 4 Ohm Stable
Signal To Noise Ratio	>95dB A-weighted	>95dB A-weighted
Sources/ Inputs	ARC/Coax/DAC(with U disk MP3 Playback/ Optical/RCA Aux/ Wi-Fi/Wireless BT	ARC/Coax/DAC(with U disk MP3 Playback/ Optical/RCA Aux/ Wi-Fi/Wireless BT
Output	Dedicated Subwoofer Single RCA	Dedicated Subwoofer, Single RCA
Lan-Rj45	Yes	Yes
Maximum Sample Rate	44.1kHz, 48kHz	44.1kHz, 48kHz
Bit Resolution	16-24 bits	16-24 bits
Gain	Analog, 30dB Digital: 0dBFS	Analog, 25dB Digital: 0dBFS
Supports 24bit/192khz	NO	NO
Online Music	Spotify, Amazon Music, Tidal, Napster, Tunein Internet Radio, iHeartRadio, vTuner,	Spotify, Amazon Music, Tidal, Napster, Tunein Internet Radio, iHeartRadio, vTuner,
Stream Protocol	Airplay and DLNA	Airplay and DLNA
Wall Mountable	Yes	Yes
Remote Control	Yes	Yes
Dimensions (L x H x D)	8.56" x 1.73" x 7.44"	7.48" x 1.73" x 5.51"
Weight	3.86 lbs. (1.75 kg.)	2.76 lbs. (1.25Kg)

Warranty Info

All OSD NERO electronics products have a (2) year Limited Warranty against defects in materials and workmanship. Proof of purchase must accompany all claims. During the warranty period OSD AUDIO will replace any defective part and correct any defect in workmanship without charge for either parts or labor. OSD AUDIO may replace returned speakers with a product of equal value and performance. In such cases, some modification to the mounting may be necessary and are not OSD AUDIO's responsibility.

For this warranty to apply, the unit must be installed and used according to its written instructions. If necessary, repairs must be performed by OSD AUDIO. The unit must be returned to OSD AUDIO at the owner's expense and with prior written permission. Accidental damage and shipping damage are not considered defects, nor is damage resulting from abuse or from servicing performed by an agency or person not specifically authorized in writing by OSD Audio.

OSD AUDIO sells products only through authorized dealers and distributors to ensure that customers obtain proper support and service. Any OSD AUDIO product purchased from an unauthorized dealer or other source, including retailers, mail over dealers and on-line sellers will not be honored or serviced under existing OSD AUDIO warranty policy. Any sale of product by an unauthorized source or other manner not authorized by OSD AUDIO shall void the warranty on the applicable product.

Damage to or destruction of components due to application of excessive power voids the warranty on those parts. In these cases, repairs will be made on the basis of the retail value of the parts and labor. To return for repairs, you must email customer service at RMA@audiogeargroup.com for a Returned Merchandise Authorization (RMA) number# then the unit must be shipped to OSD AUDIO at the owner's expense, along with a note explaining the nature of service required. Be sure to pack the unit(s) in a corrugated container with at least 3 inches of resilient material to protect the unit from damage in transit.

This Warranty Does Not Cover:

Damage caused by abuse, accident, misuse, negligence, or improper operation (installation) • Any products that have been altered or modified • Any product whose identifying number of decal, serial #, etc. has been altered, defaced or removed • Normal wear and maintenance.

The information contained in this guide is believed to be accurate and reliable. OSD assumes no responsibility for any errors contained in this guide. OSD reserves the rights to make changes in the specifications and/or design of the above-mentioned product without prior notice. The diagrams contained in this guide may not fully represent the product that you are using, and they are for illustration purpose. OSD assumes no responsibility for any differences between the product mentioned in this guide and the product you may have.



